

ELETRIC COMB BINDING MACHINE

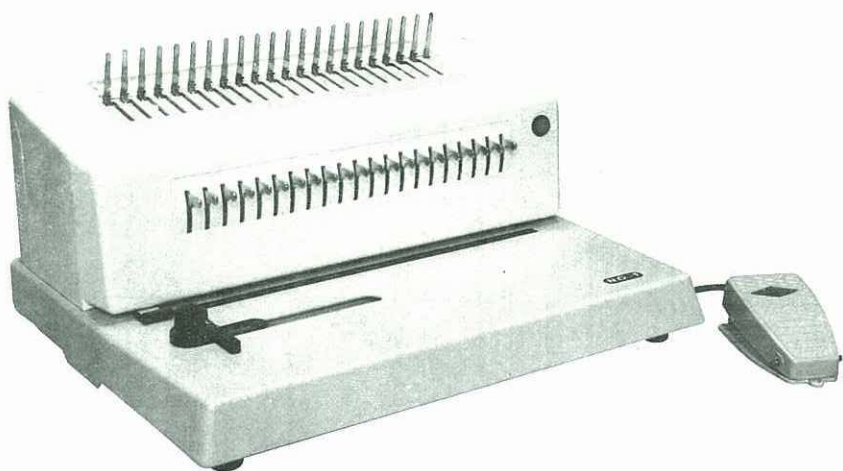

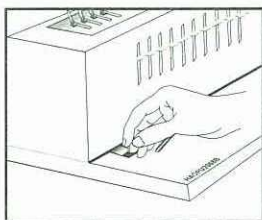

Margin depth setting.

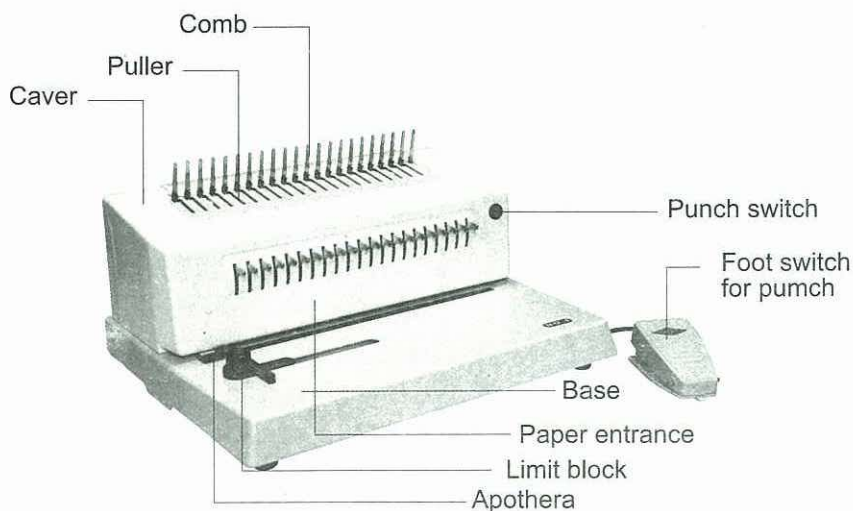
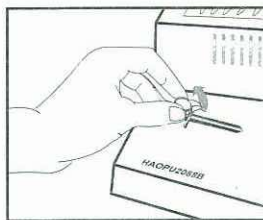

Adjust paper size for A4 & litter size.

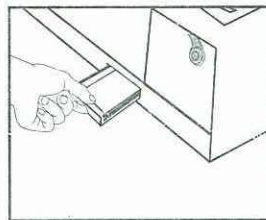

Take out the paper wasterbox and empty it.

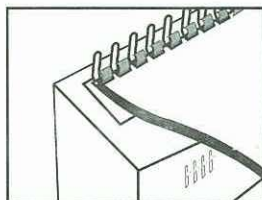

Place the disassembling files to the back of comb opening upwords.

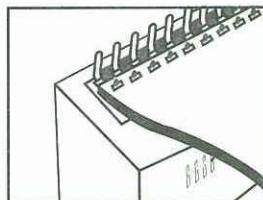

Push the handle backward to open the plastic rings.

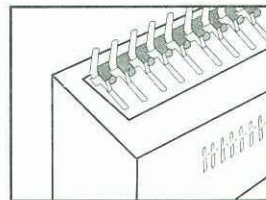

Take out the files when opening the rings.

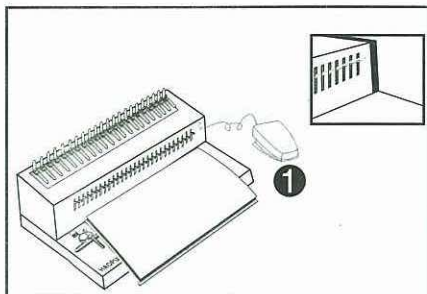

Put in paper and adjust "limit block" to centre the paper. Adjustable push-pull pins for setting punch holes.

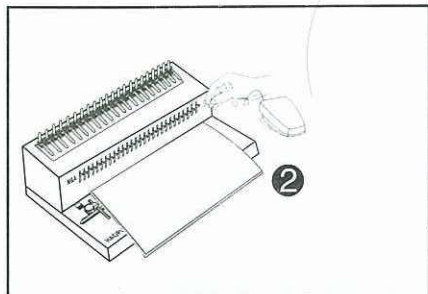

Pull down the switch or use the foot switch to punch holes, then lift back to the original place.

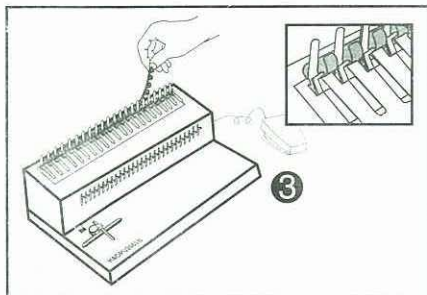

Place the plastic rings to the back of comb opening upward.

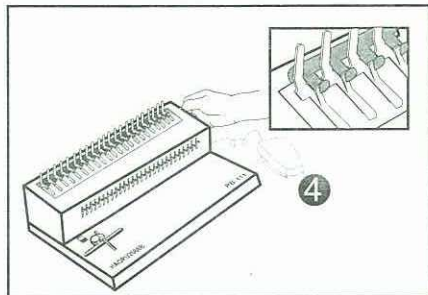

Push the handle backward and let the hoors engage the rings to open the plastic rings.

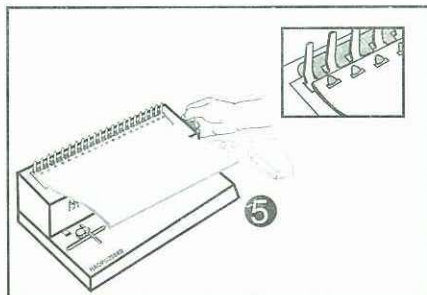

Msert the binded paper into the plaxstic rings and draw the handle back.

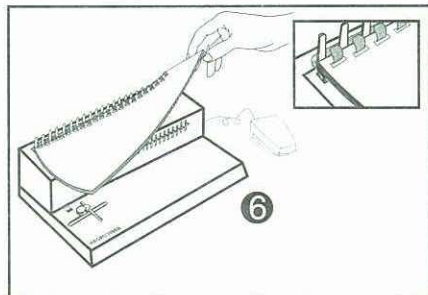

Take out the fininshed files from comb.ok.

SPECIFICATIONS

Binding capacity	500 sheet/25mm
Paper size	Below than A4 paper
Pwnohing	capacity 25 sheet (80g paper)
Facilities	21 international shandard hole distance
Characteristic	3 different adjustable side guide
Power supply	220V/50HZ, 120V/60HZ
Powre	120W
Dimension & weight	400 × 350 × 216mm/15Kg